

SolarTech Power Solutions

Differences between bifacial modules and double-glass modules



Overview

In summary, the primary difference between a bifacial module and a double glass bifacial module is the presence of glass on both sides in the latter, which provides improved durability and potential front-side efficiency advantages. Do bifacial modules come with frames?

As a result, most glass-glass modules come with frames in place. Compared with standard glass backsheet technology, framed modules with two layers of glass are heavier. Therefore, transparent backsheets are a solution for a lighter bifacial module. A more lightweight module means less cost on transportation, labor, and trackers whenever applicable.

Why are glass-glass bifacial modules becoming more popular?

Due to their better reliability, glass-glass bifacial configurations have a larger portion of the worldwide bifacial module market share. Glass shortages, weight concerns for larger format modules, and decreasing prices for transparent backsheets have caused some manufacturers to switch to a glass-transparent backsheet structure.

Does Trina Solar have a dual glass bifacial module?

However, Trina Solar has made such a breakthrough by abandoning the backsheet and developing the brand-new dual glass module. Trina Solar Vertex TSM-DEG21C.20 (670 W) framed dual-glass bifacial module.

What is the difference between bifacial and double glazed panels?

The double-glazed design gives them a transparent or translucent appearance, which is different from the opaque single-sided panels. Main difference: The design of single-sided panels is simpler and lighter, while bifacial double-glazed panels are heavier and have a more complex and modern appearance due to the double-glazed structure. 2.

What is bifacial glass technology?

Bifacial glass technology is the preferred material among manufacturers for the rear side cover of the modules. Some key advantages of the glass-glass structure are: Glass-glass modules can also be frameless, which helps eliminate the cost of an extruded aluminum frame. However, glass-glass models with frames have a lower risk of breakage.

What is a dual glass module?

Our dual glass modules use the same internal circuit connection as a traditional glass-backsheet module but feature heat-strengthened glass on both sides. We produce the back glass with a unique drilling technique that ensures the reliability of both the junction box installation and the module.

Differences between bifacial modules and double-glass modules

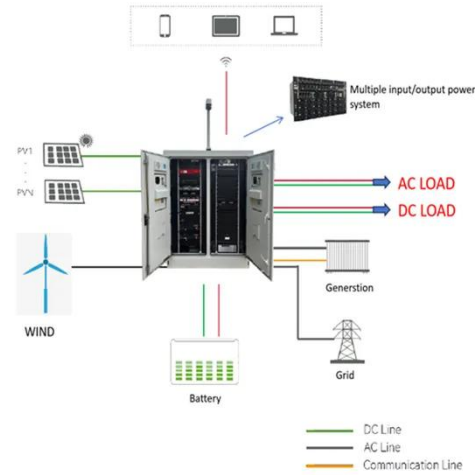

The Difference Between Single Glass and Double Glass Solar ...

Oct 2, 2024 · In the ever-evolving world of solar energy, choosing the right type of solar module can feel like navigating through a maze. Among the myriad of options, two types stand out: ...

Differences between double-glass photovoltaic modules

What is the difference between double-glass solar panels and single-sided solar panels? The main difference between double-glass photovoltaic modules and single-sided glass solar ...

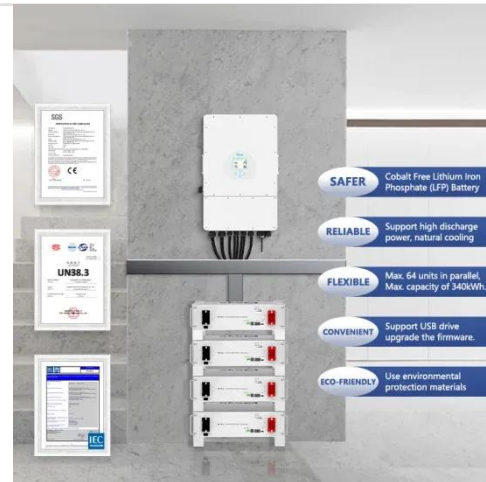

Towards 50 Year Lifetime PV Modules: Double Glass vs. Glass...

Mar 29, 2024 · Bifacial modules with double glass architectures have been deployed to capture the rear-side irradiance thereby increasing the light captured. The choice of a double glass ...

Key Differences Between Half-Cut Modules & Bi ...

May 17, 2024 · The selection between half-cut modules and bi-facial modules hinges upon factors such as project requisites, site conditions, and budgetary ...



What are the differences between single-glass ...

Oct 22, 2020 · Single-glass Solar Module: As the first layer of materials in the solar module structure, tempered glass can effectively protect the panel and ...

What is the Difference between Single Glass and ...

Aug 7, 2024 · Discover the key differences between single glass and double glass solar panels. Learn about efficiency, durability, and cost to choose the best for ...



TRANSPARENT BACKSHEET VS. DUAL GLASS WHITE

PAPER

Jul 30, 2023 · TRANSPARENT BACKSHEET VS. DUAL GLASS WHITE PAPER dules (TB) and dual glass bifacial modules (GG). This white paper evaluates advantages and disadvantages ...



What are the advantages of dual-glass Dualsun modules?

Aug 18, 2025 · The thickness of the front glass generally used for this type of structure is 3.2 mm. Dual-glass type modules (also called double glass or glass-glass) are made up of two glass ...



Single Glass Vs Double Glass Solar Panels , Best ...

May 4, 2025 · Understanding the difference between single glass and double glass solar panels is essential for selecting the right option for your energy ...

A comprehensive review and outlook of bifacial photovoltaic ...

Nov 1, 2020 · The glass-glass structure of the bPV modules contributes to a lower cleaning frequency [32] and longer lifetime, than mPV modules that have the traditional glass-organic ...



DISTRIBUTED PV GENERATION + ESS

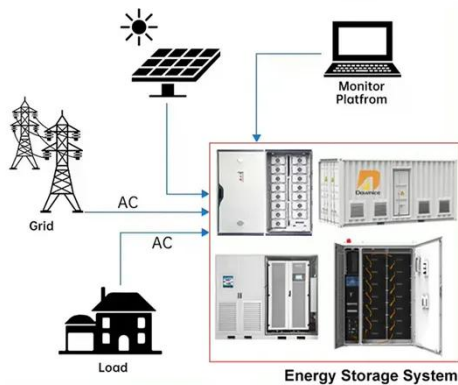

JinkoSolar: Transparent backsheet vs dual glass

Mar 10, 2020 · Based on a study of the two types of bifacial products and a long-term outdoor performance test carried out by JinkoSolar, comparisons from multiple perspectives are ...

Bifacial single glass encapsulation of solar module - An ...

Jul 1, 2025 · Outdoor performance of PV modules encapsulated with two different approaches showed that annual power generation of single glass solar modules was higher than that of ...



TRANSPARENT BACKSHEET VS. DUAL GLASS WHITE PAPER



Jul 30, 2023 · VS. DUAL GLASS WHITE PAPER but customers have a choice between transparent backsheet bifacial modules (TB) and dual glass bifacial modules (GG). This white ...

Comparison of Glass/Glass and Glass/Backsheet PV Modules Using Bifacial

Mar 5, 2015 · Bifacial solar cells can be encapsulated in modules with either a glass/glass or a glass/backsheet structure. A glass/backsheet structure provides additional module current ...

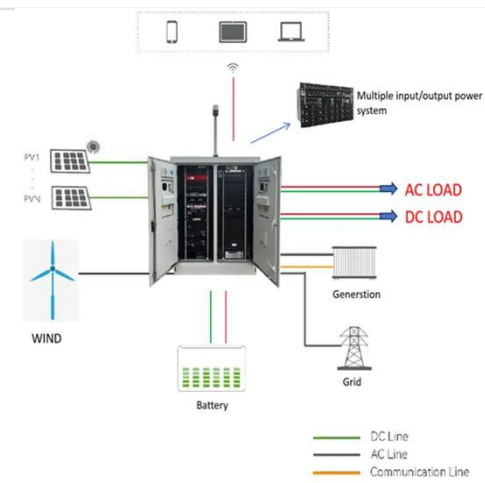

JA Solar PV Bifacial Double-glass Modules Installation

...

Jul 18, 2025 · The connection between photovoltaic module and photovoltaic module bracket should be in the form of fixed aluminum alloy press block standard parts, rail groove insertion ...

What Is the Difference Between Bifacial G2G and

Bifacial G2TB?

Bifacial G2G: Offers superior durability due to the double glass construction, making it more resistant to physical damage and environmental wear.
Bifacial G2TB: While durable, the ...



Contact Us

For catalog requests, pricing, or partnerships, please visit:
<https://www.posecard.eu>